

- Registration/Wardrobe
- Restrooms
- Catering
- Stairway
- Elevator

Ground Floor



1. Floor



2. Floor

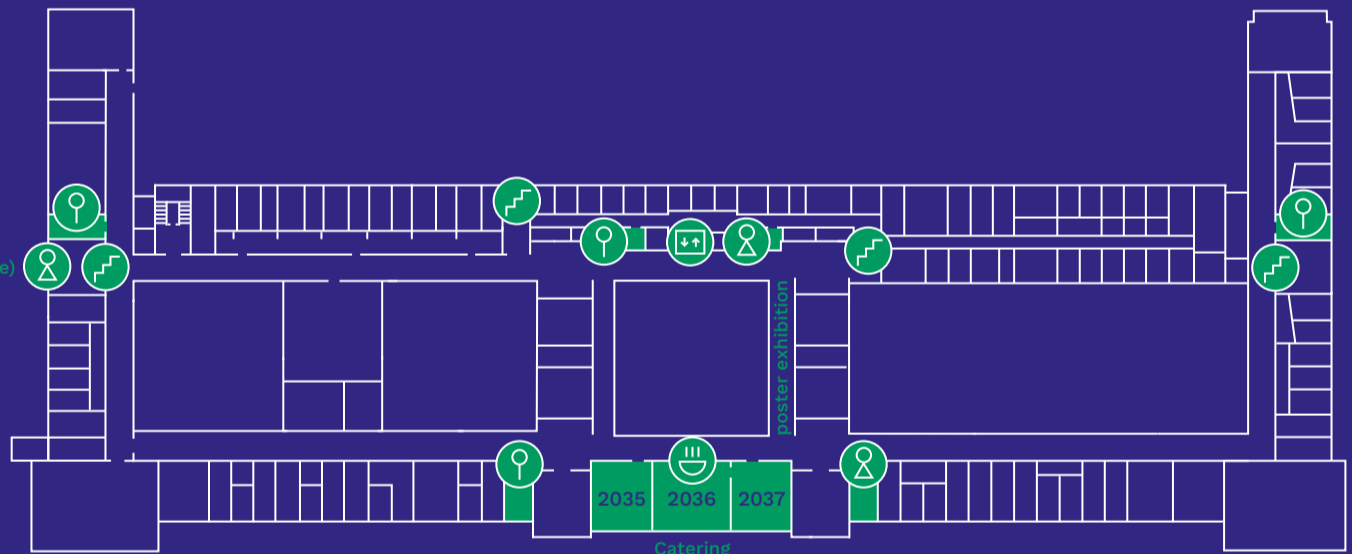

3. Floor

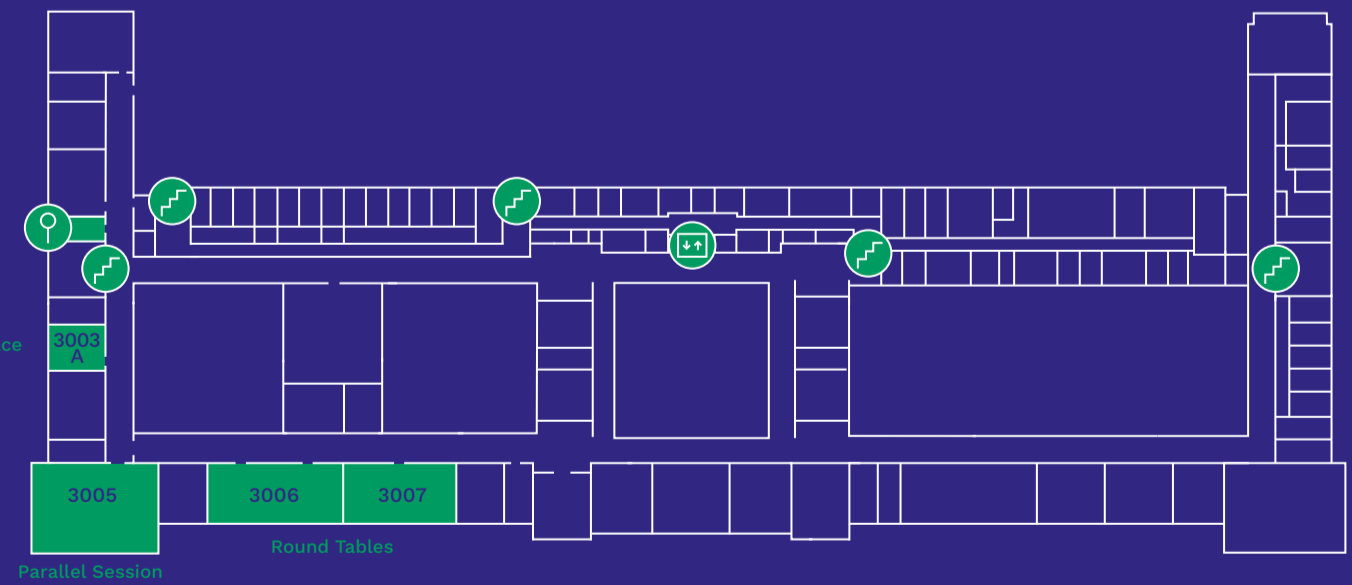

Welcome to the What Works Climate Solutions Summit 2024!

This program flyer gives you an overview of the conference venue and the program.

If you have any questions or problems, our team will be happy to help you – you can recognize us by our green lanyards. You can also reach us at +49 174 9066365.

We wish you an inspiring and successful conference!

Hosts



Partners



Sponsors



Program Overview

A fully packed program awaits you! And this is just the overview: To browse through all presentations and learn more about the sessions and presenters, please visit our website: wwcs.science/presentations or use the QR code.

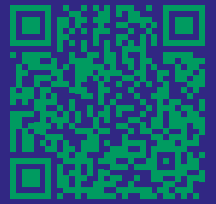

Sunday, June 9, 2024

| | |
|-------------|--|
| 14:00–15:00 | Arrival & Registration |
| 15:00–16:50 | Keynote by Marina Romanello Keynote by Andy Haines → H 0104 Followed by the panel discussion “Human health – Game changer in climate policy and evidence to action?” |
| 16:50–17:20 | Coffee Break → H 1035, 1036 |
| 17:20–19:00 | Keynote by Julian Elliot → H 0104 Followed by the panel discussion “Towards a rigorous knowledge base on what works for evidence-based climate policies and enhanced IPCC assessments” |
| 19:00–21:00 | Evening Reception → H 1035, 1036 |

Monday, June 10, 2024

| | | | |
|-------------|--|--|--|
| 07:30–8:30 | Registration | | |
| 08:30–9:45 | Keynote by Rohini Pande → H 0104 Followed by the panel discussion “The critical role of evidence-based policy to solve the climate crisis” | | |
| 09:45–10:15 | Coffee break → H 1035, 1036, 2035, 2036, 2037 | | |
| 10:15–12:00 | Keynote by Jim Skea → H 0104 Followed by the panel discussion “Towards solution-oriented IPCC assessments” | | |
| 12:00–13:00 | Lunch → H 1035, 1036, 2035, 2036, 2037 | | |
| 13:00–14:30 | Informing global climate assessments → H 0110 | Adaptation pathways and scenarios for the AR7 → H 0111 | Aligning evidence on climate change mitigation and health → H 0112 |
| | New approaches to ex-post climate policy evaluation → H 0104 | Urban typologies → H 3005 | Mitigation policy: mixed methods → H 0107 |
| 14:30–15:00 | Coffee Break → H 1035, 1036, 2035, 2036, 2037 | | |
| 15:00–16:30 | Science and policy interface → H 0110 | Informing climate solutions for adaptation → H 0111 | Advancing climate, health and equity outcomes through local action in the Indo-Pacific → H 0112 |
| | Climate solutions and cities: evidence synthesis → H 3005 | Rigorous evidence on climate policies → H 0104 | Evidence-based policy approaches to building small-scale farmers’ climate resiliency → H 0107 |
| 16:30–17:00 | Coffee Break → H 1035, 1036, 2035, 2036, 2037 | | |
| 17:00–18:30 | Keynote by Winston Chow → H 0104 Followed by the panel discussion “Challenges for policy learning from highly localized evidence” | | |
| 18:30–19:30 | Transfer to Wasserwerk for Conference Dinner | | |
| 19:30–23:00 | Conference Dinner → Eventlocation Wasserwerk, Hohenzollerndamm 208a, 10717 Berlin | | |

Tuesday, June 11, 2024

| | | | |
|-------------|---|---|---|
| all day | Poster Exhibition → 2. Floor, next to Catering area | | |
| 07:30–8:30 | Registration | | |
| 08:30–09:15 | Keynote by Massimo Tavoni → H 0104 Followed by the panel discussion “Past, Present, Future – towards comprehensive policy analysis in the IPCC’s 7th Assessment Report” | | |
| 09:15–09:30 | Coffee break → H 1035, 1036, 2035, 2036, 2037 | | |
| 09:30–11:00 | Mitigation policy: modelling → H 0110 | Tracking climate change adaptation from multiple lines of evidence → H 0111 | Land use: sectoral interventions → H 0112 |
| | Climate Adaptation and Resilience (CLARE) → H 03005 | Political economy of climate policy II → H 0104 | Rigorous evidence on climate policies → H 0107 |
| 11:00–11:30 | Coffee break → H 1035, 1036, 2035, 2036, 2037 | | |
| 11:30–13:00 | Addressing justice in global climate mitigation scenarios → H 0110 | Mapping and synthesizing evidence on global adaptation progress → H 0111 | Climate and health: evidence synthesis → H 0112 |
| | Cities solutions in cities: buildings and transport → H 3005 | Computational social science for climate → H 0104 | Synthesizing the evidence from carbon pricing policy evaluations → H 0107 |
| 13:00–14:00 | Lunch → H 1035, 1036, 2035, 2036, 2037 | | |
| 14:00–15:00 | Keynote by Edith Ofwona Adera → H 0104 Followed by the panel discussion “The Global Adaptation Tracking Initiative – challenges & opportunities” | | |
| 15:00–15:30 | Coffee break → H 1035, 1036, 2035, 2036, 2037 | | |
| 15:30–17:00 | What works in non-state climate action → H 0110 | Adaptation policy: evidence synthesis → H 0111 | Climate and health: policy → H 0112 |
| | Climate risks and adaptation in cities I → H 3005 | Meta-research in economics and environmental science “methods and applications” → H 0104 | Demand side mitigation potential → H 0107 |
| 17:00–17:30 | Coffee break → H 1035, 1036, 2035, 2036, 2037 | | |
| 17:30–18:30 | Accelerating progress towards the SDGs: insights from the Global SDG Synthesis Coalition → H 0104 | | |

Wednesday, June 12, 2024

| | | | |
|-------------|---|---|---|
| 07:30–8:30 | Registration | | |
| 08:30–09:45 | Keynote by Samantha Cheng Keynote by Cheikh Mbow → H 0104 Followed by the panel discussion “The role of nature-based solutions in international climate policy” | | |
| 09:45–10:00 | Coffee break → H 1035, 1036, 2035, 2036, 2037 | | |
| 10:00–11:30 | Nutrition and well-being of women and children in LMICs → H 0110 | Climate risks and adaptation in cities II → H 0111 | Digital evidence synthesis tools in climate and health → H 0112 |
| | Political economy of climate policy → H 3005 | Mitigation policy: evidence synthesis II → H 0104 | Qualitative evidence synthesis → H 0107 |
| 11:30–12:00 | Coffee break → H 1035, 1036, 2035, 2036, 2037 | | |
| 12:00–13:30 | Research priorities for climate and health → H 0110 | Adaptation policy: evaluation → H 0111 | Mitigation policy: evaluation → H 3006 |
| | Land use: evidence synthesis → H 3005 | Accelerating low-carbon energy transitions → H 0104 | |
| 13:30–14:30 | Lunch → H 1035, 1036, 2035, 2036, 2037 | | |
| 14:30–16:00 | IDRC → H 0111 | UNICEF child-sensitive climate policies and programs → H 0112 | Review ecosystem on the state of knowledge in CDR → H 3005 |
| | Side Event: Democracy and Climate in Crisis Three Perspectives The event is hosted by the Climate Change Center Berlin Brandenburg 14:30–15:30 → H 0106 | | |
| 16:00–16:30 | Coffee break → H 1035, 1036, 2035, 2036, 2037 | | |
| 16:30–17:30 | Closing Panel: The Future of Evidence in Climate Policy → H 0104 | | |